

DESCRIPTION AND MATERIAL	<ul style="list-style-type: none"><li>• Molded neoprene.</li><li>• Two to eight contacts.</li><li>• Up to 600 VDC.</li><li>• Up to 10,000 PSI, mated.</li><li>• Glass reinforced epoxy puck with o-ring seal provides waterblock in event of damage to neoprene face of bulkhead.</li><li>• Bulkhead connector design open face pressure rated to 5000 PSI.</li><li>• Contacts gold plated per MIL-G-45204.</li></ul>
CABLE	<ul style="list-style-type: none"><li>• Inline connectors in this series are molded on a standard 24" length of cable, #20 AWG, unless otherwise specified.</li><li>• Bulkhead connectors have 12" teflon leads, Type E per MIL 16878/4, two to four contact - #20 AWG, five to eight contact - #22 AWG.</li></ul>
USES	<ul style="list-style-type: none"><li>• Light to medium duty applications.</li><li>• Hazardous environments.</li></ul>
GUIDELINES	<ul style="list-style-type: none"><li>• All mounting surfaces require a 32 finish.</li><li>• Lubricate mating surface with 3M Silicone Spray or equivalent, DO NOT grease! Connectors must be lubricated on a regular basis.</li><li>• Lubricate o-ring with Dow Corning #111 Valve Lubricant or equivalent.</li><li>• Replace o-rings when re-using connectors.</li><li>• Avoid nicks and cuts around contacts as these are the sealing surfaces.</li><li>• Elastomers can be seriously degraded if exposed to direct sunlight or high ozone levels for extended periods of time.</li><li>• Do not over tighten bulkhead nuts.</li><li>• Do not pull on cable to disconnect.</li><li>• Avoid sharp bends at cable entry to connector.</li></ul>
ORDERING INFORMATION	<ul style="list-style-type: none"><li>• Bulkhead connectors do not come with nuts and washers. Nuts and washers should be ordered separately.</li></ul>

# MCIL/BH (WB)-2/3/4

MICRO MINI WET  
PLUGGABLE (WATERBLOCKED) SERIES

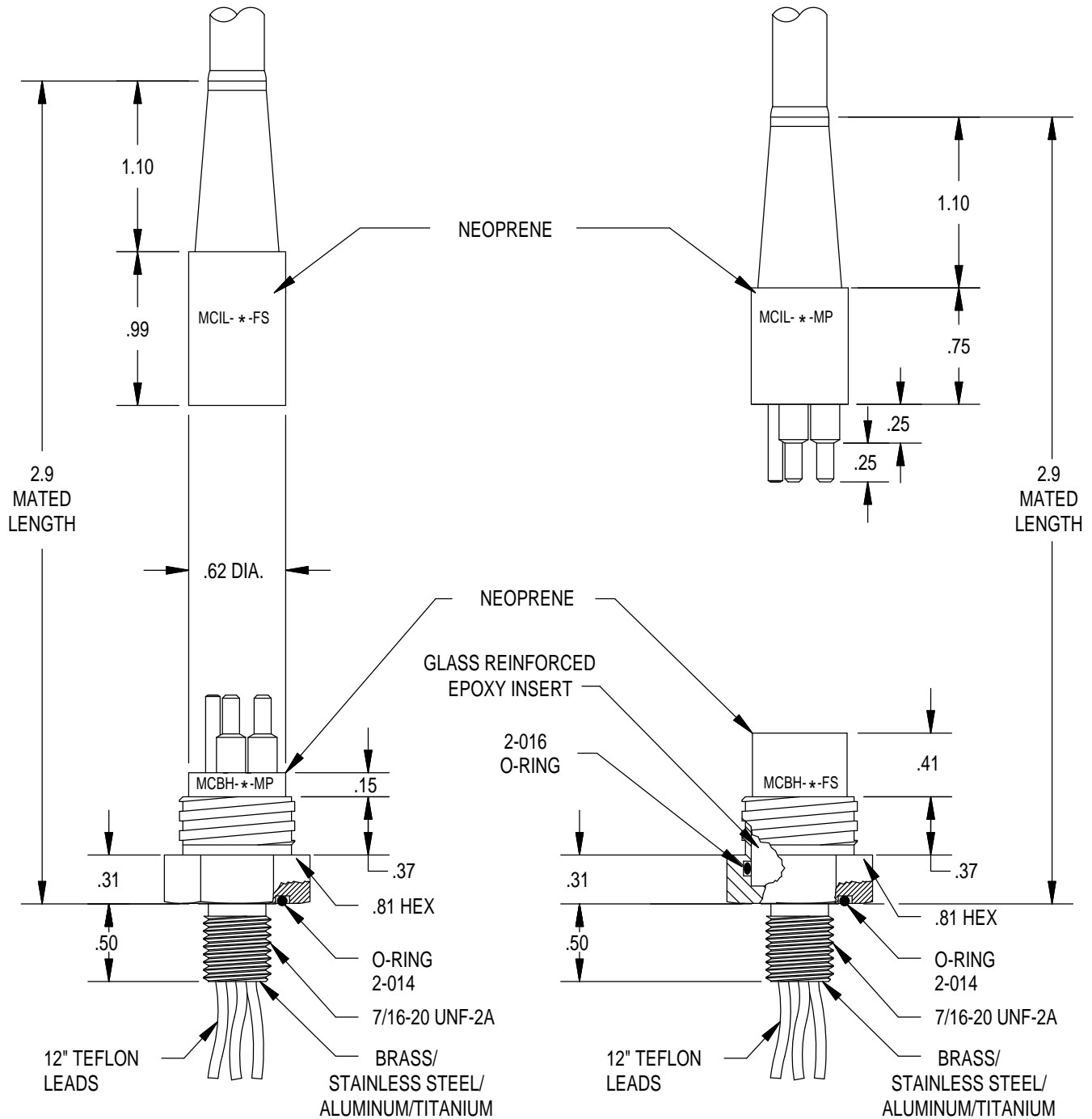

# MCIL/BH (WB)-2/3/4-R/A

MICRO MINI WET  
PLUGGABLE (WATERBLOCKED) SERIES

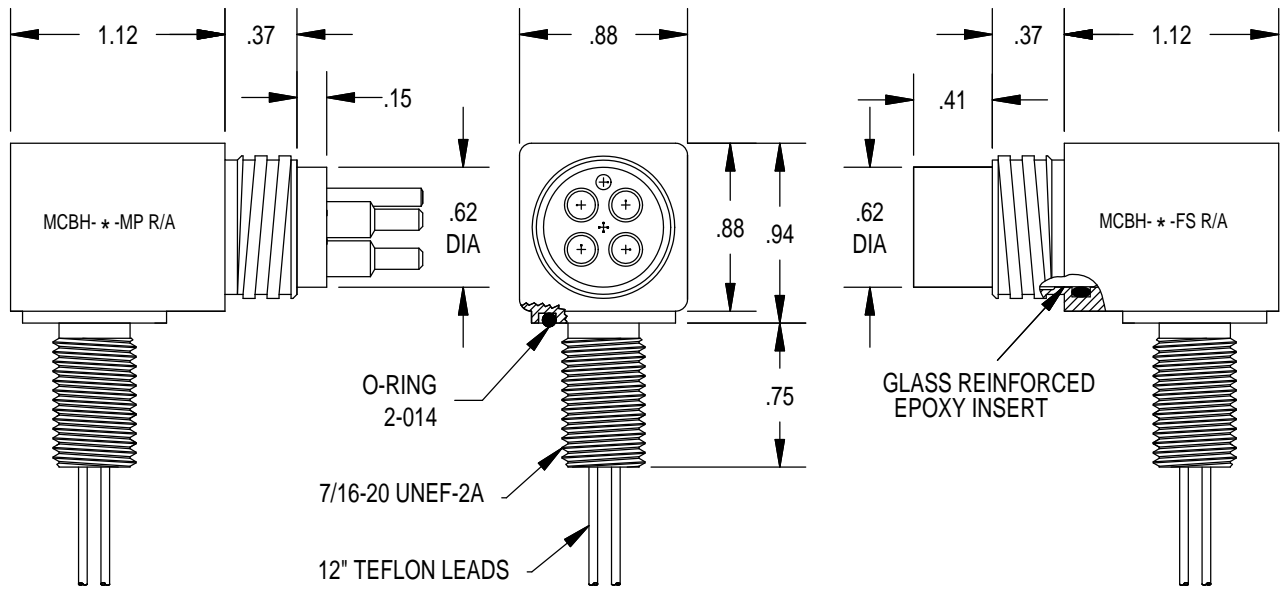

### DELTRIN LOCKING SLEEVES

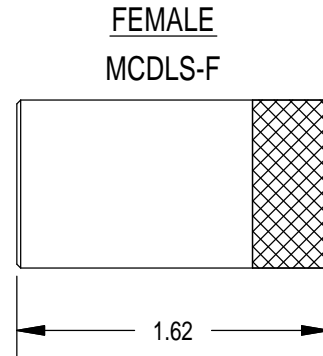
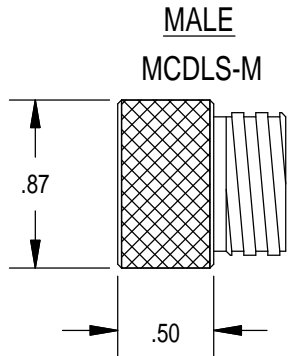

MOUNTING TORQUE FOR MCIL/BH (WB)-FS/MP	not to exceed 100 in/lbs
MATED PRESSURE RATING (psi)	10,000
DUMMY PLUG FOR MCIL/BH (WB)-FS	MCDC- * -MP
DUMMY PLUG FOR MCIL/BH (WB)-MP	MCDC- * -FS
* Specify number of contacts.	
* Dummy plugs found on page 65 125	

### CONTACT CONFIGURATION (MP FACE VIEW)

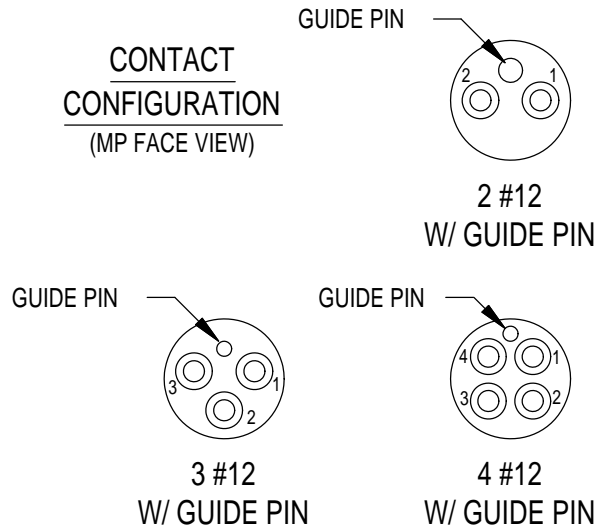

# MCIL/BH (WB)-5/6/8

MICRO MINI WET  
PLUGGABLE (WATERBLOCKED) SERIES

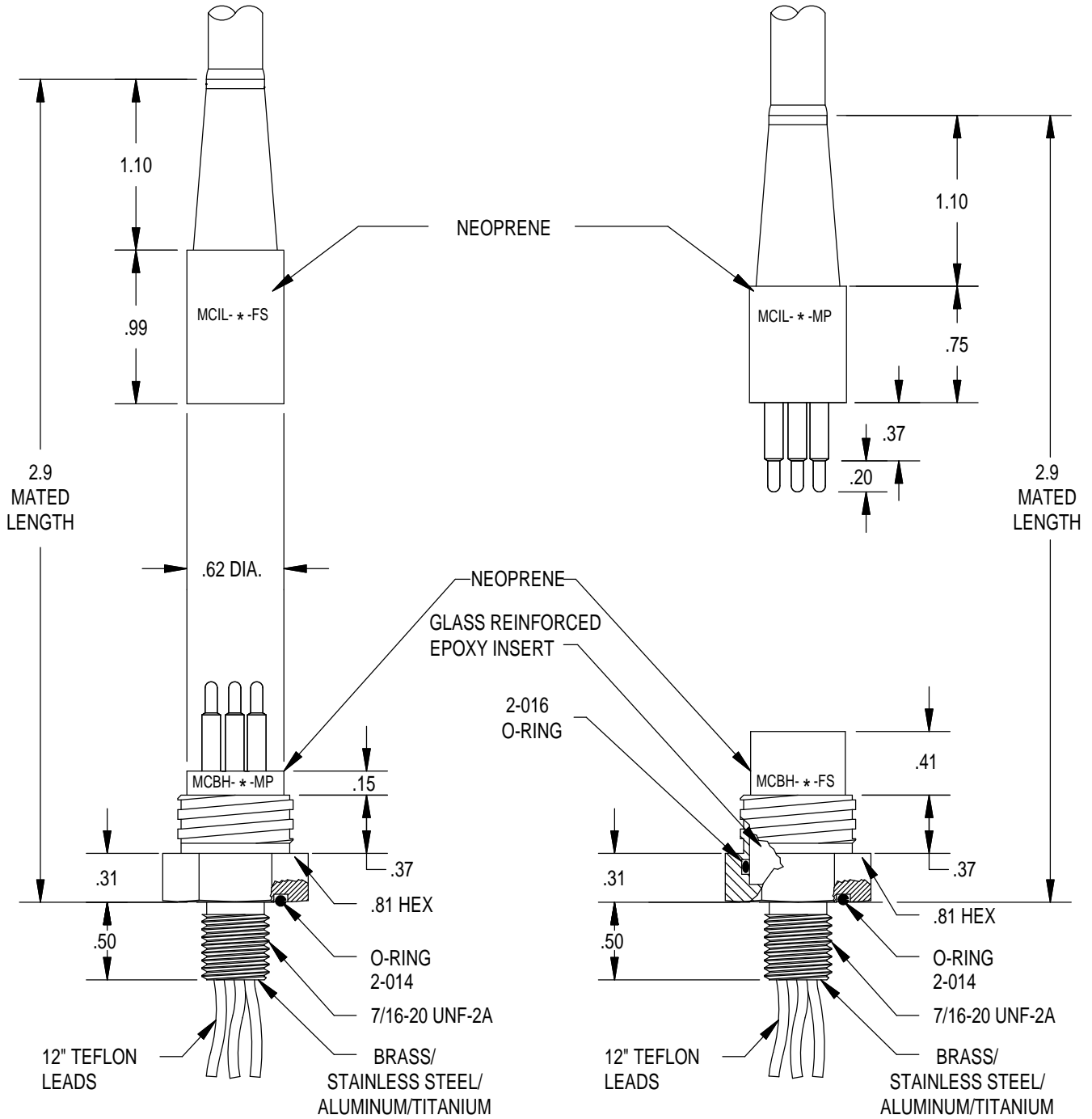

# MCIL/BH (WB)-5/6/8

## MICRO MINI WET PLUGGABLE (WATERBLOCKED) SERIES

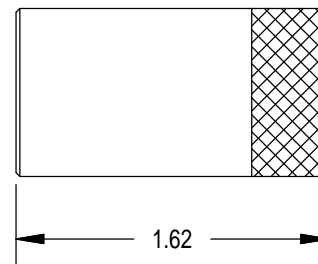
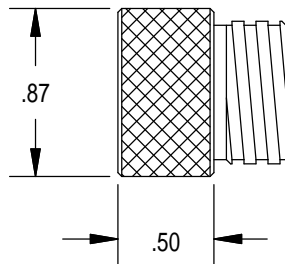
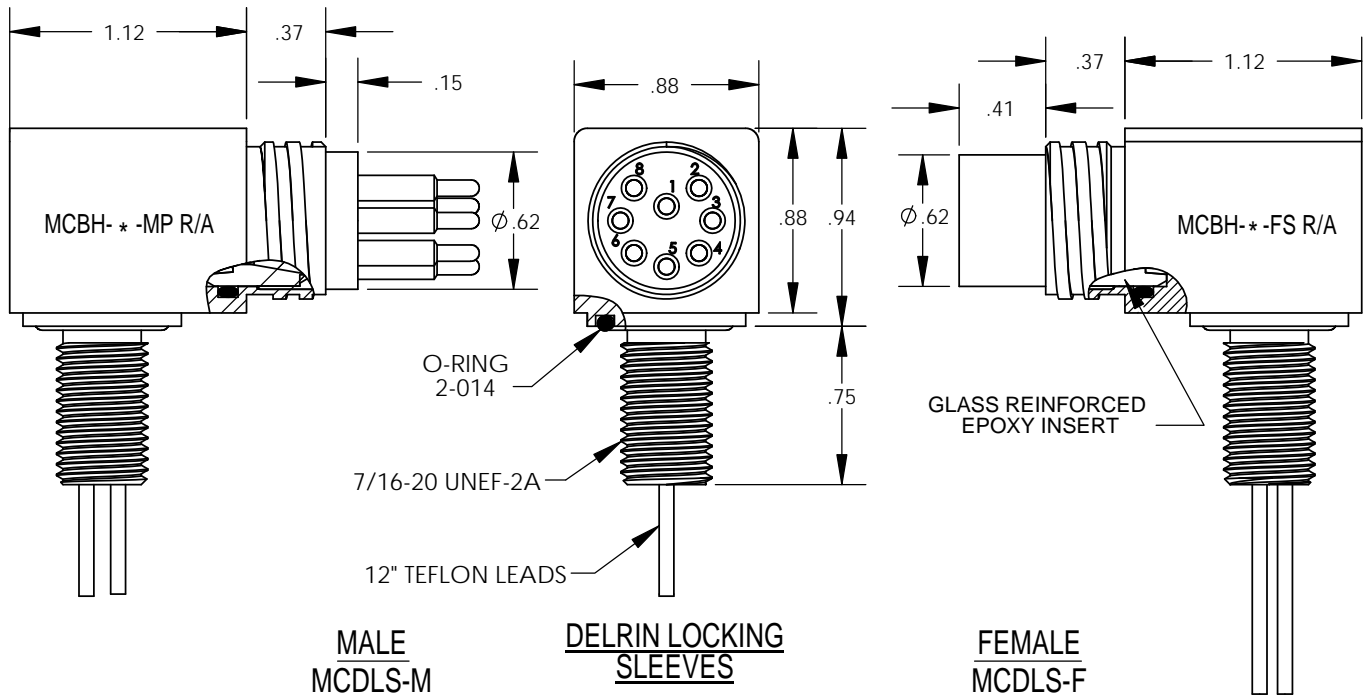

### CONTACT CONFIGURATION (MP FACE VIEW)

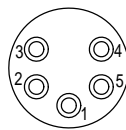

5 #15

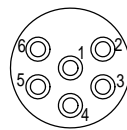

6 #15

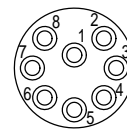

8 #15

MOUNTING TORQUE FOR MCIL/BH (WB)-FS/MP	not to exceed 100 in lbs
MATED PRESSURE RATING (psi)	10,000
DUMMY PLUG FOR MCIL/BH (WB)-FS	MCDC- * -MP
DUMMY PLUG FOR MCIL/BH (WB)-MP	MCDC- * -FS
* Specify number of contacts. * Dummy plugs found on page 65 125	

**THIS PAGE INTENTIONALLY LEFT BLANK**